

IJ-7200 Ink-Jet Transaction Printer

User's Guide

Addmaster Corporation

Address: 225 East Huntington Drive
Monrovia, CA 91016

Web: www.addmaster.com
Phone: (626) 358-2395
FAX: (626) 358-2784

Document: ij7200 user guide.DOC

Revision: 1 December 15, 2009

Notices: Subject to change without notice.
© Copyright 2009, Addmaster Corporation

Table of Contents

MANUFACTURER'S CERTIFICATION	3
CE Declaration	3
FCC-Class A Declaration	3
Important Notes	4
1 INTRODUCTION	5
1.1 Documentation	6
1.2 Emulations and Printer Models	6
1.3 Supplies and Ordering Information	7
2 INSTALLATION	8
2.1 Unpacking	8
2.2 Setup	8
2.3 Cabling: Power / Communications	9
2.4 DIP Switches	9
2.5 Peripherals	10
2.6 Ink-Cartridge	10
2.7 Roll Paper: Receipt / Journal	10
2.8 Ink-Saver Mode	10
2.9 Communications Setup	10
3 PRINTER OPERATION	11
3.1 Operator Controls	12
3.2 Indicators	13
3.2 Loading Ink-Cartridges	14
3.3 Loading Paper	15
3.4 Self-Test Procedure	16
4 TROUBLESHOOTING, MAINTENANCE & REPAIR	17
4.1 Troubleshooting Problems	17
4.2 Maintenance	19
4.3 Repair	20
5 SUPPLIES & CONSUMABLES	21
5.1 Supplies & Consumables Specifications	21
6 ABBREVIATED TECHNICAL DATA	22
6.1 Printer Operation & Features	22
6.2 Printer Dimensions and Space Requirements	22
7 DOCUMENT REVISION INFORMATION	23

Manufacturer's Certification

CE Declaration

This device complies with the requirements of the EEC directives 89/336/EEC with regard to Electromagnetic Compatibility and 73/23/EEC Low Voltage Directive. The CE mark is therefore affixed to the device or packaging.

FCC-Class A Declaration

This equipment has been tested and found to comply with the limits for a Class A digital device, pursuant to part 15 of the FCC Rules. These limits are designed to provide reasonable protection against harmful interference when the equipment is operated in a commercial environment. This equipment generates, uses, and can radiate radio frequency energy and, if not installed and used in accordance with the instruction manual, may cause harmful interference to radio communications.

Operation of this equipment in a residential area is likely to cause harmful interference in which case the user will be required to correct the interference at his own expense.

Addmaster is not responsible for any radio or television interference caused by unauthorized changes or modifications to this equipment. Unauthorized changes or modifications could void the user's authority to operate the equipment.

Important Notes

The IJ-7200 Printer is designed for use in office environments in combination with typical industry standard computing devices. Operation of the printer in other environmental conditions or uses is not supported.

- The IJ-7200 is shipped with and requires the use of a UL approved power supply. Use the printer only with the provided power supply.
- If the IJ-7200 should require repair, this work **MUST** be performed by authorized service personnel. Repairs made by unauthorized sources may lead to cancellation of the manufacturer's warranty.

Machine Safety

- Use only the specified ink-jet cartridges. Never force a cartridge into the holder. Many cartridges look similar, but have differing mounting requirements.
- Keep the original packaging. Use this packaging for shipping the printer in the future to insure against shipping damage.
- Condensation can occur when transporting the printer from a cold environment to a hot humid one. Do not operate the printer unless it is completely dry.
- Keep liquids & foreign objects from getting inside the printer mechanism or electronics. This can cause the printer to malfunction or become damaged.
- Dust, moisture, heat can all negatively affect the performance of the printer, but are unlikely to cause lasting damage. Nonetheless, protecting the unit from these factors will insure the best print quality.

Operator Safety

- **ALWAYS DISCONNECT THE POWER SUPPLY BEFORE SERVICING.** "Disconnect" means unplugging power cord, and not just turning off the power switch.

1 Introduction

The IJ-7200 Ink-Jet Transaction Printer is a modern, high-reliability transaction printer designed for use in financial, POS and other applications. The IJ-7200 prints on 3 inch wide journal or receipt paper, as well as inserted documents which may be of any size. The printer uses the Addmaster 97091 Ink-Jet cartridge.

The printer is designed for ease of use. It features a small foot-print, automated paper loading, simple intuitive operator controls and indicators, and reliable operation. The IJ-7200 is typically connected to a Host computer through industry standard interfaces. RS-232C serial, USB and Parallel interfaces are available. Printer firmware is stored in "Flash" memory, which supports field updates of firmware, fonts, and logos.

The IJ-7200 may be installed with an "emulation," which is a special set of firmware that allows that printer to operate using the command set of another manufacturer's printer. This facilitates the installation of the IJ-7200 in many applications. Emulations are described also in section 1.2.



Figure 1.1 Addmaster IJ-7200

1.1 Documentation

The printer has an associated documentation, which includes three basic items of information useful to users and software vendors:

<i>IJ-7200 User's Guide</i>	This document. Supplies the information necessary to allow the set-up and use of the IJ-7200 printer. Proper installation, maintenance, supplies are specified.
<i>IJ-7200 Specification</i>	Describes the programming and other technical details of the printer. This information is critical to applications engineers or others with similar responsibilities.
<i>IJ-7200 Flash Download Guide.</i>	Describes how firmware, fonts, or logos are downloaded into the printer. These items once in Flash memory are non-volatile and are retained even in absence of power.

Additional documentation is provided pertaining to Windows printer drivers and other miscellaneous utilities. See the corporate website for information.

1.2 Emulations and Printer Models

The model number IJ-7200 as used in this document is used in a generic sense. When optional emulations and hardware elements are added the exact model number changes. Consult the table for the current listing of models.

IJ-7200 Model Family

<i>Model</i>	<i>Emulation</i>	<i>Interface</i>	<i>Options</i>
IJ-7200-01	Addmaster	Serial & USB2	

1.3 Supplies and Ordering Information

The IJ-7200 printer is designed and tested to work with certain supplies and consumables. Use with other supplies or consumables is not tested nor supported. Consult Section 5 for specification of the approved supplies.

Supplies may be ordered directly from the factory. Contact Addmaster at:

Addmaster Corporation
225 E. Huntington Drive
Monrovia, CA 91016
USA

Phone: (626) 358-2395
FAX: (626) 358-2784

Web: www.addmaster.com

Please note that phone/FAX area codes change from time to time. Consult Addmaster's web-site for current contact information.

2 Installation

When installing the IJ-7200 printer, please follow the steps outlined in this section. Some steps may not be required in your application. Please read through the entire chapter once before beginning the installation process.

2.1 Unpacking

After unpacking, please check to see if you have received all components listed in the packing list. Check for any obvious signs of shipping damage. If you are missing any items, please contact your reseller immediately.

All packaging materials should be saved and re-used in the case the printer must be transported in the future. Also, never discard any packaging materials whatsoever, until the printer is completely installed and working properly.

2.2 Setup

The IJ-7200 printer should be installed on a flat surface, protected from extreme environmental conditions such as dust, moisture, and heat. We also recommend against installing the printer in direct sun-light as this can on occasion cause operational errors with the printer's document sensors, especially if attempting to operate the printer with its front cover (access lid) open.

Remove any protective elements added for shipping. These elements will vary depending on model and shipping method. If included, they will be indicated and specified by color coded instructions packed with the printer.

Refer to Figure 2.1 when attaching cables.



Figure 2.1 Rear Panel Connectors

Power Switch
DIP Switches

Power Connector
RS-232 Serial
USB2

2.3 Cabling: Power / Communications

Please assure that the power switch is OFF before continuing. Then cable the IJ-7200 printer in the following order:

1. Plug in the data communications cable. Attach also to proper computer port.
2. Plug the external power supply into a standard 120V outlet .
3. Plug the external power supply's power cord into the printer.

2.4 DIP Switches

Set the DIP switches as required in your application. Your reseller should inform you of the proper settings for your application. However, the defaults are the most common and it is unlikely you will have to change the DIP switches. DIP switches are accessed at the rear of the printer. The DIP switch usage on the IJ-7200 is:

<i>DIP Switch</i>	<i>Setting</i>	<i>Usage</i>	<i>Default</i>
1	ON	Firmware Download Mode	*
	OFF	Printing Mode	
2	ON	Ink-saver mode.	*
	OFF	Standard ink mode.	
3	ON	38400 Baud	*
	OFF	9600 Baud	
4	ON	Reserved for future use.	*
	OFF		

Notes:

- Firmware Download Mode is described in another document.
- The difference between Standard ink and Ink-saver mode is described in Section 2.8.

2.5 Peripherals

Not applicable for this model.

2.6 Ink-Cartridge

Installation of the ink-cartridge is described in the Section 3.2. In addition, please follow any information supplied with the ink-cartridge itself describing the removal of any protective shipping elements.

2.7 Roll Paper: Receipt / Journal

Installation of roll paper is described in the Section 3.3. Use only the proper size paper. The use of paper of smaller than specified width is not supported.

2.8 Ink-Saver Mode

If the Host computer fails to specify the ink density, the printer will select the density by reading the DIP switches. The two modes are called "standard ink" and "ink-saver."

Standard ink is the factory default setting and produces the darkest and best print quality in most applications.

Ink-saver uses one-half the ink economizing on ink usage and thereby increasing the life of the cartridge. On average, ink-saver mode extends the ink cartridge life by a factor of 2. In some cases, ink-saver may produce preferable print quality. For example, some recycled papers are very absorbent and standard ink usage may appear overly dark and fuzzy.

2.9 Communications Setup

The communications link needs to be determined based on the application. In most installations this decision is made by the applications software provider. Here are some guidelines:

Windows printer driver is used.	Use USB port.
Legacy application. Text printing only with internal printer fonts.	Serial port at 9600 baud acceptable.
Legacy application with some graphics printing.	Serial port at 38400 baud.
Serial port usage <i>required</i> , Windows printer driver used.	Serial port at 9600 baud acceptable if ONLY internal printer fonts used. Serial port at 38400 baud acceptable for graphics at low resolution (specified in driver).

3 Printer Operation

The IJ-7200 Printer is simple to operate. Controls and indicators are very intuitive and easy to use. Supplies and consumables are easy to load and remove. New users can typically be trained in a minimum of time, and only the topics presented in this section need to be covered.



Figure 3.1 IJ-7200 Operator Controls & Indicators

3.1 Operator Controls

Item	Usage
Power Switch.	Cuts power to the printer. ALWAYS USE THE POWER SWITCH TO REMOVE POWER.
Paper-Feed Button. '2'	Feeds paper forwards. Short depression: Feeds last printed line past tear-bar (about 2 inches). Long depression: Feeds paper continuously while button is depressed. Waits ½ second before beginning to feed.
Go Button. '1'	Causes action. Short depression: Services print head. Spits and wipes to clean and prepare print head when misperforming. Long depression: Causes a Printer Status Message to be printed.

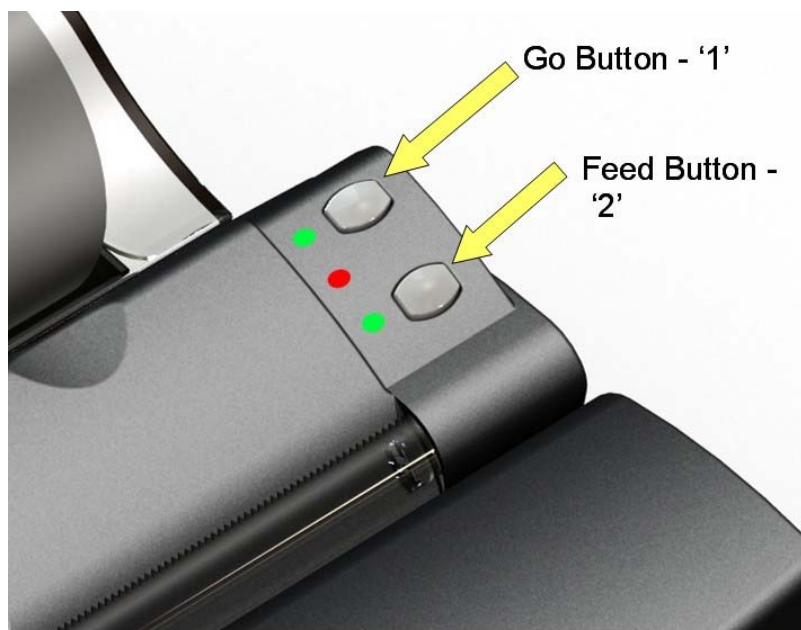

3.2 Indicators

Indicator	State	Meaning
Ready LED.	ON	Power is ON. Printer is On-Line and ready to operate.
	FLASH	N/A.
	OFF	Power is OFF or Printer is not Ready because of paper loading error.
Error LED.	FLASH	Error: one of the following Out-Of-Paper. Form requires removal. Print-head Jam.
	OFF	No errors.
Form LED.	ON	Insert form for validation.
	OFF	No form attention required.

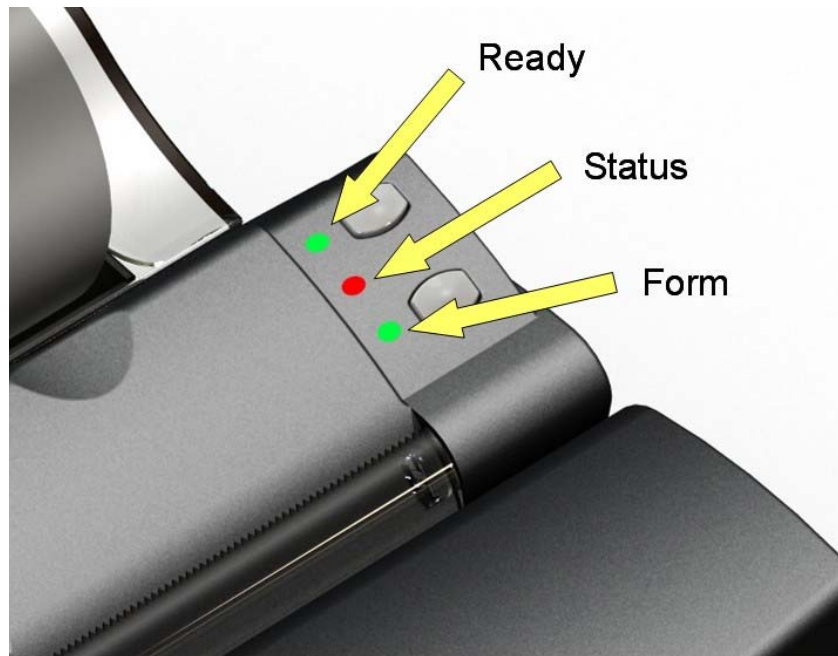

3.2 Loading Ink-Cartridges

Follow these steps when loading Ink-Jet Cartridges.

1. Be sure you have obtained the proper replacement ink-cartridge.
2. Open the new ink-cartridge. Follow any instructions packed with the cartridge.
3. Remove the printer's access lid. The lid lifts upwards.
4. Remove used ink-cartridge by squeezing release arms as shown.
5. Insert new cartridge. First, tilt the ink-cartridge and insert at a slight angle with the nozzles downwards.
6. Latch ink-cartridge into place by pressing tab forwards.

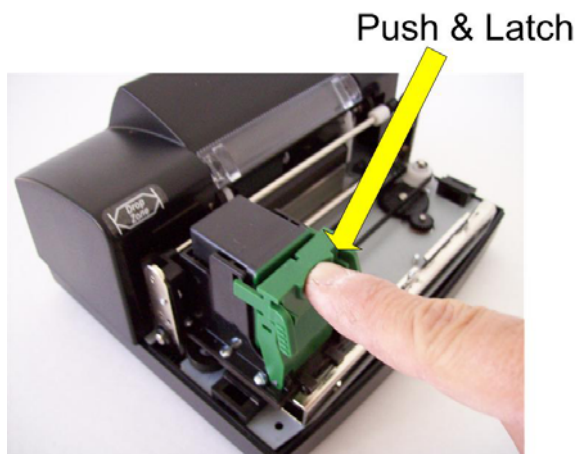
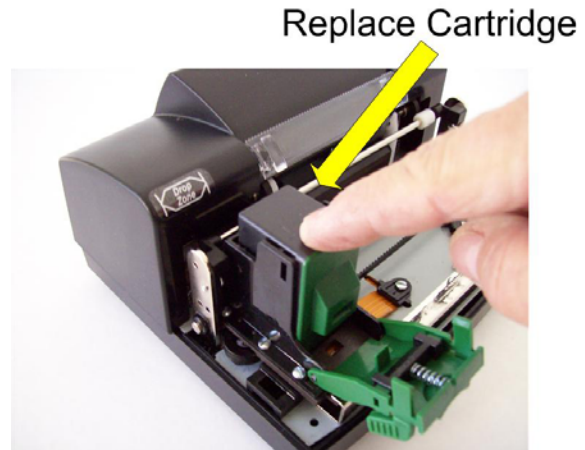
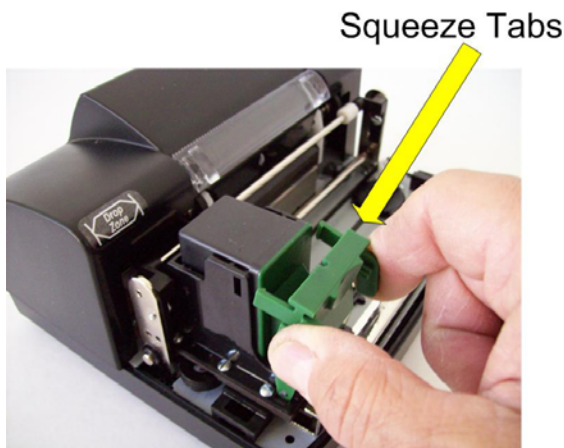

Figures 3.2 Installing the Ink-Cartridge

3.3 Loading Paper

Before installing a new roll of paper the remains of the old roll must be completely removed. Use the paper feed button to feed out the paper and then remove manually.

Step #1: Preparation.

Install the roll paper with the printer powered ON.

Make sure the paper on the new paper roll is cut or torn evenly at its end. See the illustration.

Locate the paper intake chute. The intake chute extends outwards from the rear of the printer to assist you.

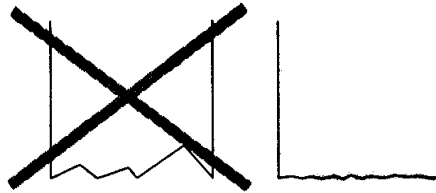

Figure 3.3 Paper Edge

Step #2: Load the Paper.

Position the paper so that the paper unwinds from the bottom.

Gather a loop in one hand. Guide this length of paper into the paper path. When the paper is inserted far enough into the printer, the feed mechanism is automatically activated and the paper is fed through the machine and its tear-bar.



Figure 3.4 Feeding the Paper

Step #3: Finish.

Close the lid.

Tear off the excess paper using the Tear-Bar.

Test the printer by printing the Printer Status Info report. (Hold down the Go Button until printing begins.)

3.4 Self-Test Procedure

After the printer is set-up and its supplies are loaded, its operation can be tested by use of the printer's "Self-Test Routine." This self-test exercises most aspects of the machine's operation and provides visual indication that the unit is properly set-up and ready for operation. The following features are tested and verified:

- Identification: Model Number, Firmware & Revision Level, Installed Options
- Operation: Printing, Feeding, Validation Clamping & Ejecting,
- Printing: All fonts and print modes.

To initiate the Self-Test, follow these steps:

1. Turn off power.
2. Hold down GO button.
3. Turn on power.
4. Release button after printing starts.
5. A sample tape is printed.
6. Press GO button again (short depression) and next message will print. Continue at step 6 as desired.
7. Insert Form to test validation mechanism. Push FEED button. Repeat step 7 or continue at step 6.

IMPORTANT NOTE:

Unit exits self-test mode automatically after any communications.

4 Troubleshooting, Maintenance & Repair

4.1 Troubleshooting Problems

Consult the proper sub-section below for information on solving the symptom.

Flashing Error LED Indicator

A flashing Error LED indicator informs the operator that one of these 2 conditions is preventing the printer from continuing operation:

- A form is inserted into the printer and the form needs to be removed.
- The print-head is jammed and not moving properly.

If a form is present, then remove it.

Check the print-head to assure it can move back and forth. Try turning the power on and off to observe the print-head.

If everything looks OK, then perhaps there is paper debris confusing the printer's paper sensors. Check for paper debris, and blow out the printer with compressed air if required.

Irregular, Missing, or No Print

- Is ink-cartridge empty? Replace if so.
- Is ink-cartridge properly installed in holder? If not, correct.
- Remove and inspect ink-jet cartridge:
 - Check the electrical contacts on both the cartridge and the carrier for ink. Wipe off any ink or foreign materials found.
 - Check for foreign objects or dried ink build up on the ink-cartridge nozzle plate. Wipe off ink or debris with a moistened paper towel, taking care not to get ink on yourself or other elements of the printer.
- If all else fails, install a new ink-cartridge.

In the unlikely event these problems were not corrected by the above steps then contact a service technician.

"Empty" cartridges still contain some ink. The cartridge cannot use all the enclosed ink, don't try to. For example, if a print job is 10 lines, the first 2 might print and the last 8 might be blank. If the print sits idle for a few minutes, a small amount of ink may bleed upwards to the nozzles to permit another 2 lines or so to be printed. This ink-cartridge is empty and should be replaced.

Irregular Paper Feed

If the paper fails to properly feed into the unit, check the following:

- The paper being fed into the unit has a straight edge with no bends,
- The paper roll can rotate freely on its supports.

Potential Validation Document Problems

The validation document needs to properly cover internal sensors before validation can begin. Cut-forms, if designed improperly, may cause problems. Check for these items:

- Is cut-form large enough? If it is too small (less than 6 inches), it may not cover both sensors. The type and use of the chrome form guide will affect this also.
- Are there any holes in the cut-form? These may prevent proper feed.

Computer Interface Not Working, Hung, or Dead

This is the most common problem, probably because so many different set-up problems can cause it.

If the computer interface WAS WORKING, but now is not, then check:

<i>Awaiting Cut-form</i>	If the FORM LED is ON, then the unit requires a cut-form to continue.
<i>Form Jam or Mechanism Jam</i>	If the ERROR LED is FLASHING, then either a document is stuck in the unit, or the print-head is jammed and cannot move. Correct the problem. You may have to turn power on and off.
<i>Computer Cable</i>	Insure that the communications cable has not been removed.

If the computer interface HAS NEVER WORKED, then check:

<i>Cabling</i>	<p>Cabling problems are the most common source of error. Typical problems:</p> <ul style="list-style-type: none">• Wrong cable,• Cabled to wrong port at PC,• Loose cable connection: make sure you have completely inserted the cables and securely screwed them into their mates.
<i>DIP Switches</i>	<p>These set important communications parameters. If these are inaccurately set, the printer will NOT work. Consult your reseller for the appropriate settings.</p>
<i>Wrong Printer</i>	<p>Possible items:</p> <ul style="list-style-type: none">• You are trying to install a serial printer, but the software is looking for a parallel printer.• Verify the printer's firmware is correct for your application by running the Self-Test.
<i>Bad Host Software Setup</i>	<p>You have improperly setup the applications software or configured your computer.</p>

4.2 Maintenance

The IJ-7200 is designed for use without preventative maintenance. However, print quality may suffer in environments which are very dusty, dirty, or humid. In these environments, we recommend the following:

T.B.D. No recommendation at this time.

4.3 Repair

Your first contact for printer repair should always be your reseller, who will arrange for the repair or replacement of your unit, should it prove faulty. If the unit is to be sent to the factory for maintenance or repair, you must first obtain an "RMA" number from the factory. Contact Addmaster at the location given in Section 1.3.

IMPORTANT NOTES: When shipping your IJ-7200

- Always use the original packaging material,
- Always REMOVE the ink-jet cartridge.

5 Supplies & Consumables

5.1 Supplies & Consumables Specifications

Paper Roll Specification

<i>Media Type</i>	Plain paper. Roll stock.
<i>Roll Diameter</i>	3.0 inches maximum
<i>Roll Width</i>	3.00 inches (+0.1/-0.2)
<i>Roll Core I.D.</i>	5/8 inches typical, (no special requirement)
<i>Thickness</i>	0.0015 to 0.03 inches
<i>Recommended Weight</i>	#16
<i>Recommended Stock</i>	Rittenhouse #7055SB

Validation Document Specification

<i>Document Type</i>	1 form, Plain paper stock.
<i>Document Thickness</i>	0.0015 to 0.0180 inches
<i>Document Width</i>	5.5 inches minimum
	6.0 inches recommended minimum
<i>Document Height</i>	2.75 inches minimum
<i>Recommended Weight</i>	#16

Ink-Cartridge Specification

<i>Print Head</i>	Manufacturer: Addmaster Corporation
	Part Number: 97091
<i>Ink Color</i>	Black
<i>Ink Cartridge Life</i>	Depends on Font
<i>Typical use</i>	Approximate results:
	1.2M characters - standard density
<i>Maximum</i>	2.4M characters - ink-saver
	Not specified.
<i>Print Contrast Ratio</i>	Constant throughout life of cartridge.

6 Abbreviated Technical Data

6.1 Printer Operation & Features

Consult IJ-7200 Specification for current technical data.

6.2 Printer Dimensions and Space Requirements

T.B.D.

Figure 6.1 Outline Dimensions: Side View

Notes:

- All dimensions are in inches.
- Dimensions are approximate. Some extra spacing should be allowed.

7 Document Revision Information

Revision	Date	Changes / Modifications
1	12-15-2009	Initial release.